

# Classic 120 XL Bed

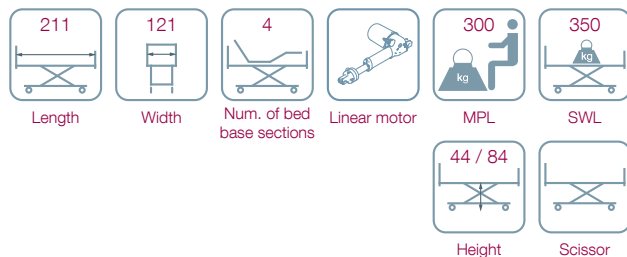

## Electric lifting chassis version



## Height-adjustable legs version

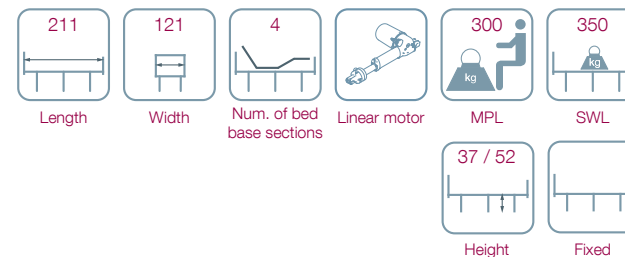

## Features

The Bariatric bed is divided into four articulated planes. There are two versions, with electric lifting chassis and with height-adjustable legs.

- Structure made of enamelled steel tubing in 60 x 20 x 1.5 mm tubing. Main body in enamelled steel tubing (100 µ) made in 40 x 20 x 1.5 tubing.
- With motor and special dimensions for bariatric patients.
- Bed base with dual motor for the backrest of 12.000 N and legs of 6,000 N with IPX6 protection rating that ensures greater protection against liquids and dust.
- Electric lifting chassis with dual motor of 16.000 N.
- Self-lubricating bushings on the bed base and an elevation system that do not need maintenance.
- Its anti-friction system improves the noise level, maintenance and durability of the bed.
- Bows in the structure of the bed to hold the mattress in place, on the welded sides and at the folding ends.
- Holders for support handle and drip support at the four corners.
- Safe working load (SWL): 350 kg
- When the bed is equipped with a chassis, the minimum range of elevation is 44 cm and the maximum is 84 cm.
- The version with adjustable legs can be adjusted to four different heights: 370, 420, 470 and 520.
- Accessible for transfer systems with 15 cm of free space under the bed when it is mounted on a chassis.
- Foot boards and head boards with standard dimensions for both models of bed. Easily detachable using ordinary spanners. Made in laminate and edged in PVC, moisture resistant and easy to clean.



# Classic 120 XL Bed

## Technical information

Total length with headboard and footboard (A)	2110 ± 5 mm.
Total length without headboard and footboard (B)	2050 ± 5 mm.
Total width without rails (C)	1210 ± 5 mm.
Minimum / maximum rest surface height with bedposts (D, E)	370 / 420 / 470 / 520 ± 5 mm.
Minimum / maximum rest surface height with lifting chassis (D, E)	440 / 840 ± 5 mm.
Bed base width (F / G / H / I)	685 / 365 / 235 / 530 mm.
Backrest tilting angle (J)	72° ± 3°
Legrest tilting angle (K)	32° ± 3°
Packed bed weight	80 kg.
Bed weight	59 kg.
Packed bedposts weight	6 kg.
Packed footboard and headboard weight	11 kg.
Maximum patient weight (MPW)	300 kg.
Safety weight load (SWL)	350 kg.
Recomended mattress dimensions	120 x 200 mm.

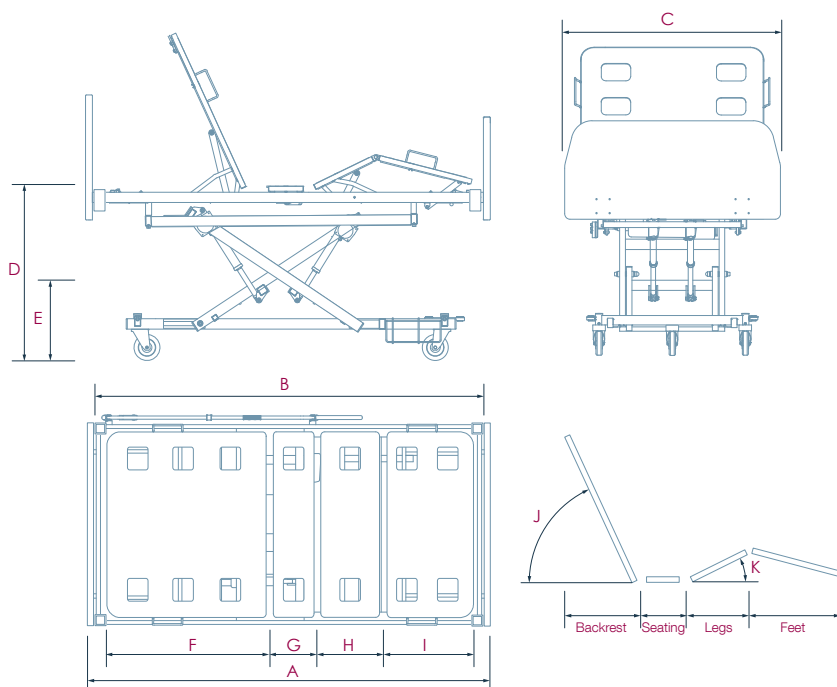

## Electrical information

Lifting system	By linear motors
Backrest and legrest lifting system	By linear motors
Voltage and frequency	230 V CA / 50-60 Hz
Electric shock protection / liquid penetration	Class II / IType B / IP66
Motor intermittent operation	10% 2 min. - 18 min

## Height-adjustable legs version

Controls	Protection	Transport	Wellness	Others
Basic patient control	Headboard and footboard in melamin	Regulable bedpost	HPL base bed sections	IV Pole Trapeze bar

## Electric lifting chassis version

Controls	Protection	Transport	Wellness	Others
Basic patient control	Headboard and footboard in melamin	Ø125 mm with centralized system (4 units)	HPL base bed sections	
		Ø125 mm with independent brake(2 units)		

## Optional

Controls	Protection	Transport	Wellness	Others
		Tubing rails		Battery